



# Think Safety

Because fire can grow and spread so quickly, having working smoke alarms in your home can mean the difference between life and death. Once the alarm sounds, you may have as few as **two minutes** to escape. Smoke alarms are the most effective early warning devices available. Just having a smoke alarm in your home cuts your chance of dying in a fire nearly in half.

The Orlando Fire Department is responsible for organizing and scheduling various community service programs.

<http://www.cityoforlando.net/executive/nso/citizencorps.htm>

For more information on smoke detectors and home safety in your community, contact the Division of Public Relations personnel listed below:

## Vicki Robles

Division Commander

Division of Public Relations

Phone: 407-246-3128

Fax: 407-246-3158

Email: [Vicki@cityoforlando.net](mailto:Vicki@cityoforlando.net)



**Orlando Fire Media  
City Hall 7th Floor  
400 South Orange Ave.  
Orlando, FL 32801**



**CITY OF ORLANDO  
FIRE DEPARTMENT**

# SMOKE ALARMS

# save lives



## Recommended Locations for Smoke Alarms

- Locate the first alarm in the immediate area of the bedrooms. Try to protect the exit path as the bedrooms are usually farthest from the exit. If more than one sleeping area exists, locate additional alarms in each sleeping area.
- Locate additional alarms to protect any stairway as stairways act like chimneys for smoke and heat.
- Locate at least one alarm on every floor level.
- Locate an alarm in every bedroom.
- Locate an alarm in every room where electrical appliances are operated (i.e. portable heaters or humidifiers).
- Locate an alarm in every room where someone sleeps with the door closed. The closed door may prevent the alarm from waking the sleeper.
- Smoke, heat, and combustion products rise to the ceiling and spread horizontally. Mounting the smoke alarm on the ceiling in the center of the room places it closest to all points in the room. Ceiling mounting is preferred in ordinary residential construction
- When mounting an alarm on the ceiling, locate it at a minimum of 4" (10cm) from the side wall (see Diagram)
- When mounting the alarm on the wall, use an inside wall with the top edge of the alarm at a minimum of 4" (10cm) and a maximum of 12" (30.5cm) below the ceiling (see Diagram)

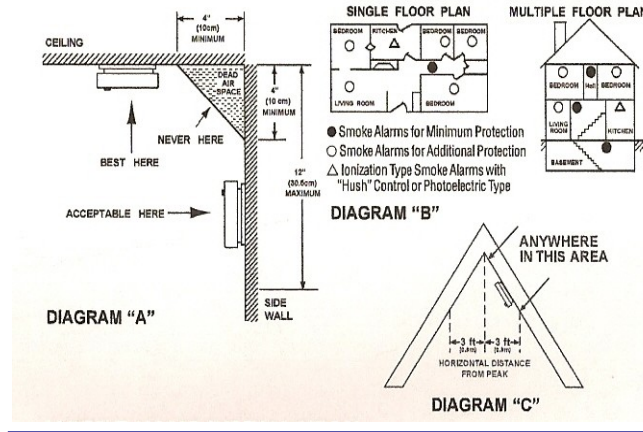

## Locations to Avoid

- In the garage. Products of combustion are present when you start your automobile.
- Less than 4" (10cm) from the peak of an "A" frame type ceiling.
- In an area where the temperature may fall below 40°F or rise above 100°F.
- In dusty areas. Dust particles may cause nuisance alarm or failure to alarm.
- In very humid areas. Moisture or steam can cause nuisance alarms.
- In insect-infested areas.
- Smoke alarms should not be installed within 3 ft (.9m) of the following: the door to a kitchen, the door to a bathroom containing a tub or shower, forced air ducts used for heating or cooling, ceiling or whole house ventilating fans, or other high air flow areas.
- Kitchens. Normal cooking may cause nuisance alarms. If a kitchen alarm is desired, it should have an alarm silence feature or be a photoelectric type.
- Near fluorescent lights. Electronic "noise" may cause nuisance alarms.

## How to keep a smoke alarm working

- Smoke alarms should be tested once a month.
- Batteries should be changed yearly.
- If your alarm is making a chirping noise it needs a new battery.
- Keep your smoke alarm clean; vacuum it at least once a month.



## Make A Plan

- Make sure everyone knows what your smoke alarm sounds like.
- Have a plan with two ways out of each room and practice it!
- Have a safe meeting place.
- Call 9-1-1 from a safe phone.
- Once you are outside of the house, **STAY OUT. NEVER** go back inside.

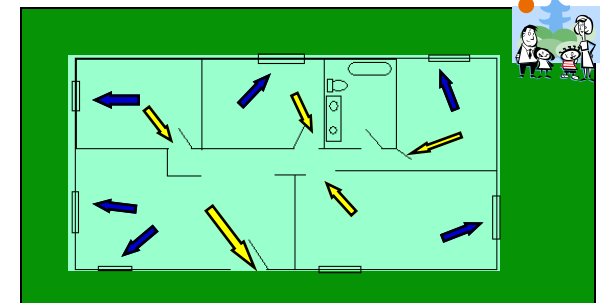

**Keep your home safe!**